



Ashwell Street

Leighton Buzzard, Bedfordshire, LU7 1BG

£1,050 PCM



  
**WATSONS**  
LETTING SINCE 1961



## Ashwell Street

Leighton Buzzard, Bedfordshire, LU7  
1BG

Watsons are delighted to offer for let this two bedroom end terrace house within a short walk of the Town Centre. The accommodation comprises: Lounge / diner, kitchen with oven and hob units, stairs to first floor, two bedrooms with built-in wardrobes, bathroom with shower above the bath, and small rear yard. The property is offered Unfurnished, and is available mid March.

### Lounge / Diner

22'5 (max) x 13'2 (max) (6.83m (max) x 4.01m (max))

### Kitchen

10'5(max) x 9'11 (max) (3.18m(max) x 3.02m (max))

### Stairs to First Floor

### Bedroom One

10'7 x 10'0 (3.23m x 3.05m)

### Bedroom Two

9'11 (max) x 9'6 (into storage) (3.02m (max) x 2.90m (into storage))

### Bathroom

### Rear Yard:





Measurements and floor plans are approximate and for guidance only. Any prospective Tenant should check all measurements. Floor plan coverings and fitments are for example only and may not represent the true finish of the property.

## Floor Plan

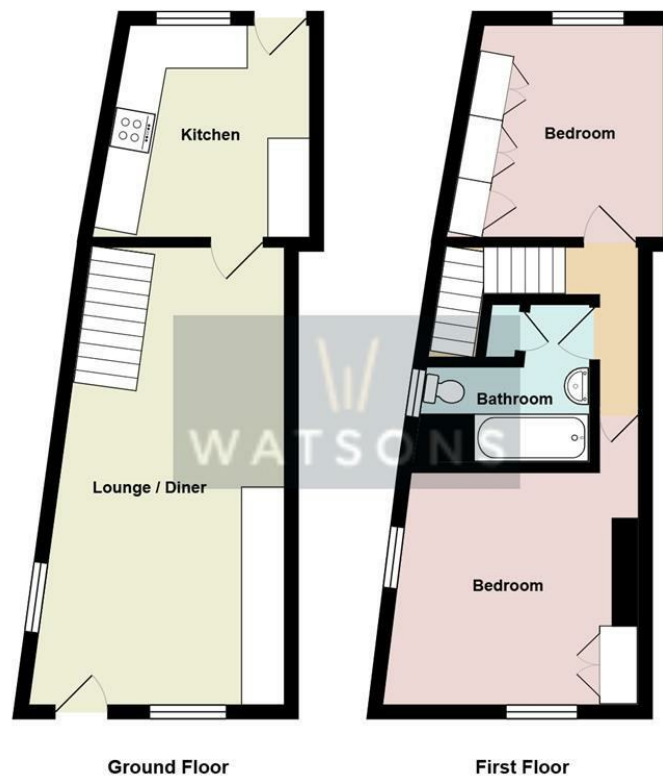

Total Area: 680 ft<sup>2</sup>

All measurements are approximate and for display purposes only

## Viewing

Please contact our Watsons Lettings Office on 01525 378309 if you wish to arrange a viewing appointment for this property or require further information.

17 - 21 Ropa Court, Leighton Buzzard, Bedfordshire, LU7 1DU  
Tel: 01525 378309 Email: [info@watsonslb.co.uk](mailto:info@watsonslb.co.uk) [www.watsonslb.co.uk](http://www.watsonslb.co.uk)